

CLSI WALL PACK



Product Description

CLSI led wall pack has a same beautiful look as traditional wall packs, but with over 120-130lm/W light efficiency, best aluminum heat dissipation sink. equipped with long lasting driver which last 50000hrs, ideal for replacing old wall packs 100-600W.

Application

Outdoor building, Wall area, General area and Security lighting etc



Electric Characteristic

Specification/Model	CLS-WP41W	CLS-WP60W	CLS-WP80W	CLS-WP100W	CLS-WP120W	CLS-WP150W	CLS-WP60W-HP	CLS-WP80W-HP
LED Chips	Philip3030							
Input power	41W	60W	80W	100W	120W	150W	60W	80W
Lumens output	4920-5330LM	7200-7800LM	9600-1040LM	12000-13000LM	14400-15600LM	18000-19500LM	7200-7800LM	9600-1040LM
Efficiency	120-130LM/W							
CRI	75Ra							
Color Temperature	3000/4000K/5000K							
Input voltage	100-277V UL Driver						200-480V UL Driver	
Lighting beam	120D							
Power Factor	0.9							
Total Harmonic Distortion	13.4%							
lamps efficiency	90%							
Certificates	ETL, CETL, DLC							
Equivalent	100-150W MH/HPS 1	50-200W MH/HPS	250-300W MH/HPS	300-350W MH/HPS	350-450W MH/HPS	450-600W MH/HPS	50-200W MH/HPS	250-300W MH/HPS

Ordering Information

Example: CLS-WP41W-30K-N-T

Product	Power	Replacement	Color Temperature	Photocell	Furnish
CLS-WP41W(5000K)	41W	100-150W MH/HPS	30K=3000K 40K=4000K 50K=5000K	N not photocell Y yes photocell	WP=Wall Pack
CLS-WP60W(5000K)	60W	150-200W MH/HPS			
CLS-WP80W(5000K)	80W	250-300W MH/HPS			
CLS-WP100W(5000K)	100W	300-350W MH/HPS			
CLS-WP120W(5000K)	120W	350-400W MH/HPS			
CLS-WP150W(5000K)	150W	450-600W MH/HPS			

Photometri

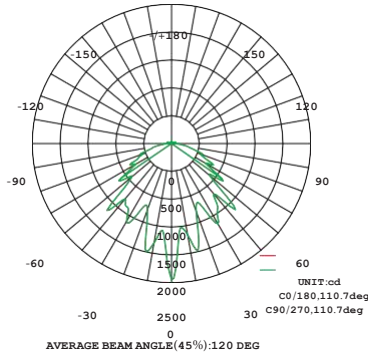

Projected LED Lumen Maintenance

Operating hours	0	25000	50000
Lumen maintenance factor	1	0.91	0.8

Data references the extrapolated performance projections for the WALLPACK LED platform in a 25°C ambient, based on 10,000 hours of LED testing (tested per IESNA LM-80-08 and projected per IESNA TM-21-11)

Dimensions:

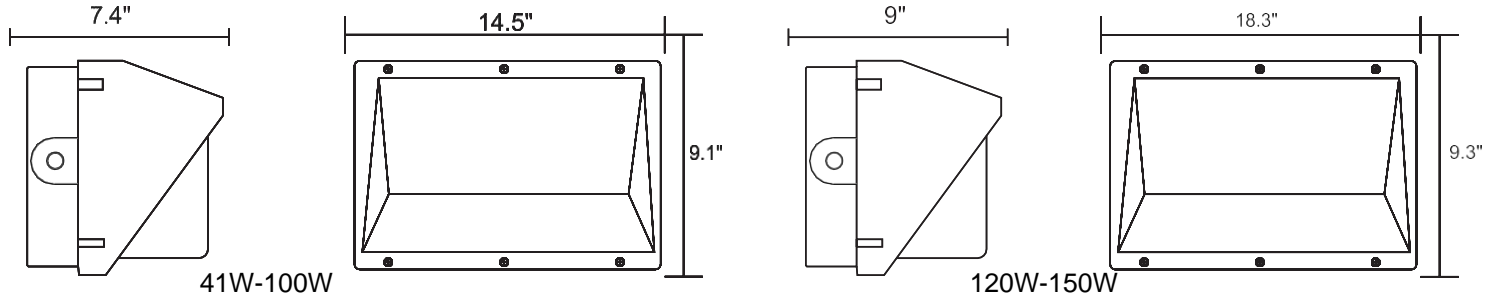

After sale Service:

The product refers to electricians knowledge. Please don't disassemble it by yourself. If any quality problem happens, please contact the factory for warranty details

NOTE: Actual performance may differ as a result of end-user environment and application. All values are without notice